

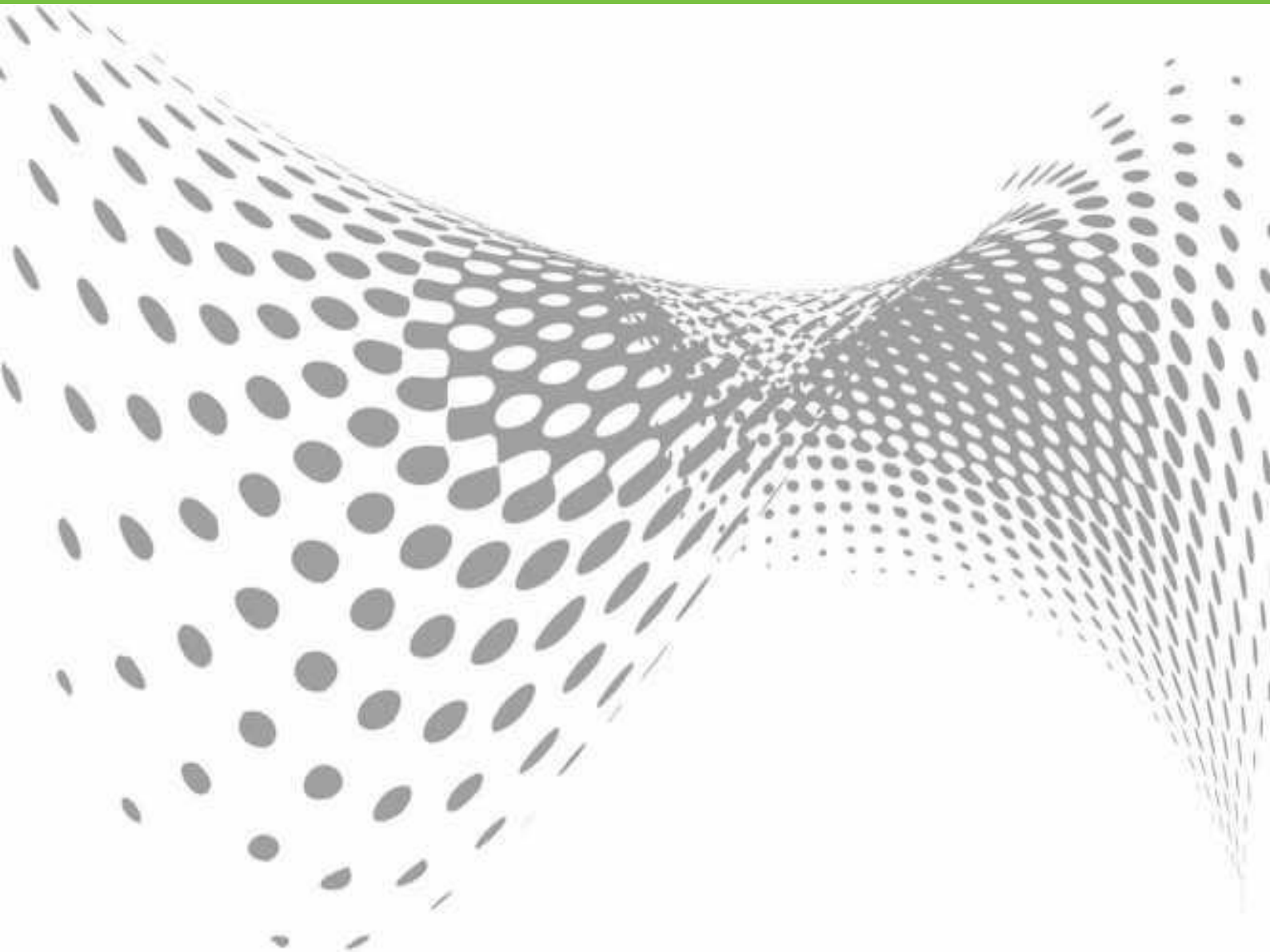

S4A INDUSTRIAL CO., LIMITED

Intelligent Multi-function integrated Card Lock

# Operating Manual



Please carefully read this brochure

## Preface

Great honor be your choice to our products, please carefully read below listed contents in the instruction before using.

1. Working Voltage: 4X AA 5# alkaline batteries (not included in shipping), please do not install any unqualified or poor batteries.
2. Please install the battery to test whether the function is normal before installation. If there is any problem, please contact the dealer or manufacturer in time;
3. It is forbidden to install the product by electric welding. During the process of electric welding, the temperature of the product will rise rapidly and the product will be damaged. Moreover, electric welding will generate strong arc radiation, which can easily lead to damage/power consumption of this product.
4. If it is installed on an iron or stainless steel door, please mark the location of the improved hole on the door before drilling. The lock must not be fixed on the door and then drilling holes in the position, which will leave iron chips in the lock, these iron chips will be adsorbed on the magnetic head under the circuit board, causing damage to the circuit board!!
5. When installing the outer lock core, please open the lock core hole with a diameter of no less than 30MM on the door, and polish the edge to avoid sharp edge of the opening hole, which may lead to broken skin or fracture of the edge wiring of the outer card reader.
6. This lock is not an escape door lock, it's forbidden to be installed on fire escape door, or else at your peril!!!
7. This manual is applicable to multiple models of the same series of products;
8. Due to the unstable real environment and other reasons, the actual values of some data may be inconsistent with those provided in this manual. In case of any doubt or dispute, our company's final interpretation shall prevail.

## Product Feature

1. Power supply: 4X AA 5# alkaline batteries (not included in shipping)
2. Battery life: more than 1 year or more than 30,000 times of switch lock (Just our testing)
3. Remote control capacity: 30 users ( Optional)
4. Card capacity: 1000 users
5. Automatic lock: support, delay 10 seconds
6. Door closing reaction anti-interference: support, delay 0.5 seconds

# Operation Instructions

## Add or remove wireless Remote control

Add Remote Control	Operation Instructions	Notes
Method	After swiping the management card once, the indicator light flash Press any key of the remote control keypad and hear 3 times of "D that means add successful.	Supported for continuously add remote "control
Remove Remote control	Operation Instructions	Notes
Remove single remote control	After swiping the management card once, the indicator light flashes. Press any key of the remote control keypad and hear "urgent quacking" that means remove successful.	Supported for continuously remove remote control
Remove all remote control	After swiping the management card once, the indicator light flashes. Input "9191#" in the remote control keypad and hear 3 times of "Di" that means remove successful.	Remove all remote control

## Add or remove User Card

Add user card	Operation Instructions	Notes
Method 1	After swiping the management card once, the indicator light flashes. Brush the user card that need to be added, and then hear 3 times of ,Di" that means add successful.	Supported for continuously add user card
Method 2	After swiping the management card once, the indicator light flashes. Use the Remote control keypad input 7-10 digital number (user card) & press"#",and hear 3 times of "Di" that means add successful.	The Digital "0" in front of the Card number no need input
Remove user card	Operation Instructions	Notes
Method 1	After swiping the management card once, the indicator light flashes. Brush the user card that need to be remove, and hear "urgent quacking" that means remove successful.	Supported for continuously add user card
Method 2	After swiping the management card once, the indicator light flashes. Use the Remote control keypad input 7-10 digital number (user card) & press , and hear "urqent quacking" that means remove successful.	The Digital "0" in front of the Card number no need input
Remove all user card	After swiping the management card once, the indicator light flashes. Use the Remote control keypad input "9090#" , and then hear 3 times of "Di" that means remove successful.	The Master card is not remove

## Advanced functions setting

Normally open mode On	Operation Instructions	Notes
Method 1	After swiping the management card once, the indicator light flashes. Use the Remote control keypad input "2021#" , and then hear 3 times of "Di, that means add successful.	This mode will automatically exit after opening the lock by swiping the card/remote control/button, and the mechanical key/single head rotation will not exit
Method 2	Press and hold the unlock and lock keys of the remote control keypad for 1 second at the same time, and hear 3 times of "Di" that means add successful	
Adjust system response speed	Operation Instructions	Notes
The fastest response time	After swiping the management card once, the indicator light flashes. Use the Remote control keypad keypad input "58300#" , and then hear 3 times of "Di" that means add successful.	Power consumption increases, the mode please external power supply
Factory default speed	After swiping the management card once, the indicator light flashes. Use the Remote control keypad input "58301#" , and then hear 3 times of "Di" that means add successful.	Powered by batteries that the user experience and power consumption are optimized
The slower response time	After swiping the management card once, the indicator light flashes. Use the Remote control keypad input "58302#" , and then hear 3 times of "Di" that means add successful.	For users who value battery life, the system response speed is slightly slower
The slowest response time	After swiping the management card once, the indicator light flashes. Use the Remote control keypad input "58303#" , and then hear 3 times of "Di" that means add successful.	Standby time is very long, suitable for the case of very few unlock times, the system response speed is very slow

The "Di" of the infrared remote control is for empty input, "99#" exit the Infrared.

## Other Setting

Function	Operation Instructions	Notes
Configuration Master card	Press and hold the reset key on the motherboard, and hear 3 times of "Di" & release the key, the indicator light flashes, Brush the Master card that need to be configured, 3 times of "Di" means configured successful.	
Automatic add Card	Brush the Master card once, the indicator light flashes; Use the Remote control keypad input "95#" , and then hear 3 times of "Di" that means configured successful.	
	Brush the Master card once, the indicator light flashes; Use the Remote control keypad input "95#" & input add card number (1-999) #, and then hear 3 times of "Di" that means configured successful (Eg: input 9510# that automatic add 10 card and stop).	
Turn off automatic add card	Brush the Master card once, the indicator light flashes; Use the Remote control keypad input "96#" , and then hear 3 times of "Di" that means turn off successful.	
Clear all Users & Remote control	Press and hold the reset key on the motherboard, and hear 12 times of "Di" & release the key, and then hear 3 times of "Di" means clear successful.	The master card not cleared
Factory Reset	Press and hold the reset key on the motherboard, and hear 8 times of "Di" & release the key, and then hear 3 times of "Di" means reset successful.	It is only Factory reset, not clear user data.

## Interface specification

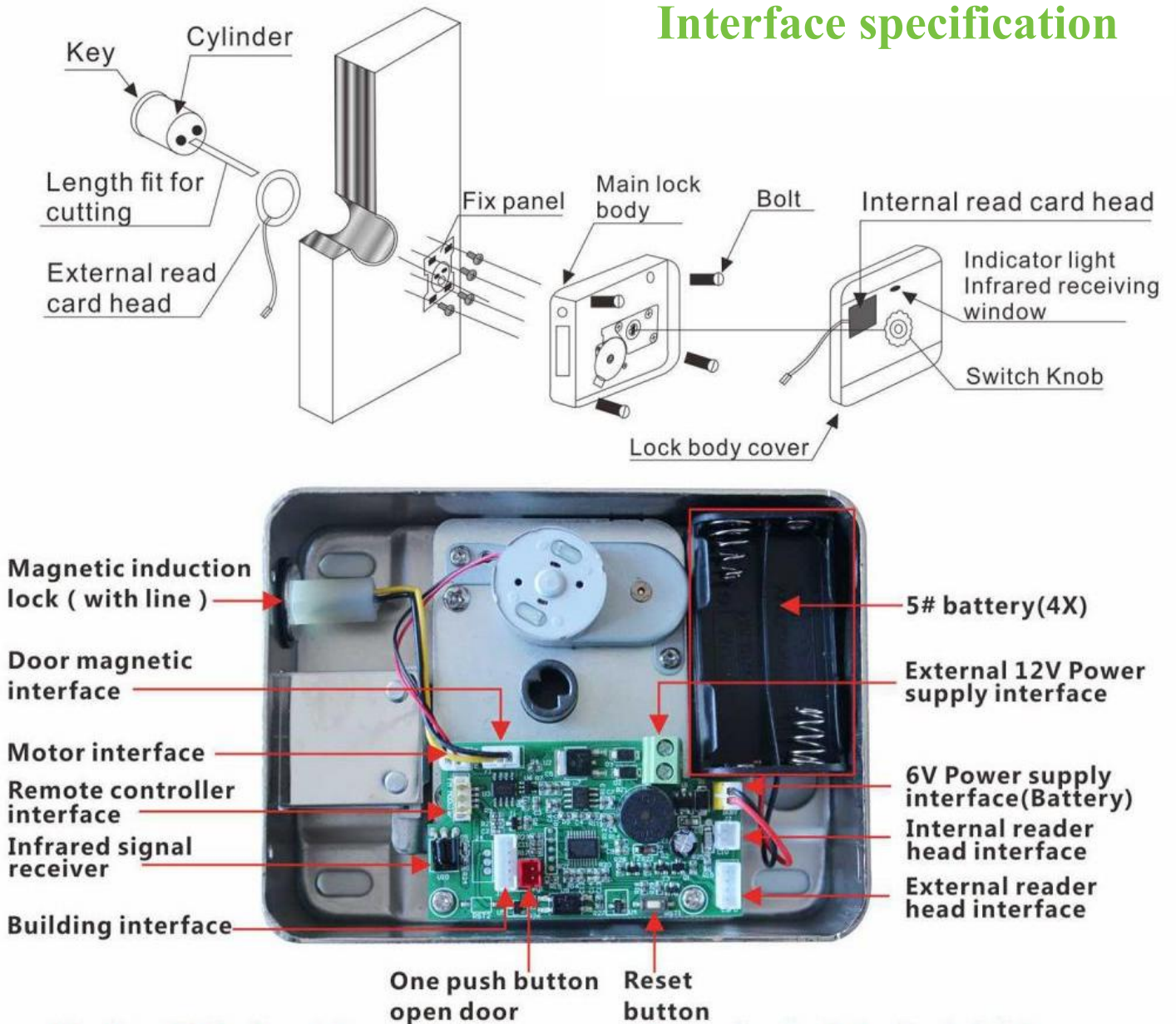

Note: This lock is not an escape door lock, it's forbidden to be installed on fire escape door, or else at your peril!!!

### Warranty Card

When this product is returned to the factory for maintenance, please fill in the information carefully. This product is guaranteed for one year.

Purchase date \_\_\_\_\_

Purchase channel \_\_\_\_\_

Contact number \_\_\_\_\_

### Certification

Production date  
\_\_\_\_\_

Inspector  
\_\_\_\_\_

Product serial number  
\_\_\_\_\_